

**FRANKE**

**FRANKE**

**Franke Home Solutions**  
**franke.com.hk**

Authorised Dealer of The B.S.C. Group  
11/24

Distributor of Hong Kong  
B.S.C. Group of Companies  
Address: 19th Floor, Sino Favour Centre, 1 On Yip Street, Chai Wan, Hong Kong  
Tel: +852 2510 2328  
Website: [www.bschk.com](http://www.bschk.com)

BKEE – 專為商戶而設的裝飾建材批發網  
Website: [www.bkee.com](http://www.bkee.com)  
Facebook: [facebook.com/BKEEOnline](https://www.facebook.com/BKEEOnline)  
YouTube: BKEE – 專為商戶而設的裝飾建材批發網  
Tel: +852 9815 9250 (WhatsApp)  
Email: [cs@bkee.com](mailto:cs@bkee.com)

All pictures, specifications and other content in this catalogue are the property of Franke and shall not be reproduced in any form of media without the expressed written permission from Franke.

All product images and specifications are subject to the actual technical data. Franke reserves the right to make any changes and modifications, without prior notice, resulted from technology development.

Printed in November 2024

**COLLECTIONS**  
**2025**



# A Great Performance Deserves a Great Stage



THE SHOW IS HOME

**FRANKE**



# COLLECTIONS 2025

## ABOUT US

- 6 Brand Introduction
- 26 Innovation/ Awards

## PRODUCT CATEGORIES

### Sinks

- 28 Overview and Highlights
- 34 Fraganite Sink
- 42 Stainless Steel Sink
- 56 Accessories

### Taps

- 68 Overview and Highlights
- 72 Brass Tap
- 76 Stainless Steel Tap
- 77 **Clean & Care**
- 78 **Food Waste Disposer**
- 82 **Our Projects**







# Years of experience, yet still as curious as kids.

At Franke, we have been looking for new solutions and innovations for over 100 years and our attitude still has not changed. In 1911 we combined traditional craftsmanship, precision engineering and a constant pursuit of innovation, three principles that remain at our core.

## A story forged in Swiss precision

Our story began at the beginning of the last century as a small sheet-metal business in Rorschach, Switzerland, established by Hermann Franke.

Since then, we opened up to the world and inaugurated manufacturing facilities all around the globe that led us to become leaders in the kitchen sinks segment, and home solutions altogether.





# The recipe for a healthier future

We're on a mission to help create a more sustainable planet, one innovation at a time. From designs built with the use of sustainable materials, to efficiency optimization and waste reduction, we act responsibly throughout our business and beyond for positive long-term impact.



## Taking care of the environment

Franke joined the United Nations Global Compact and adopted the Ten Principles of the United Nations Global Compact for sustainable and responsible business in 2011 and has reported on its material sustainability impacts annually since.

By 2050, we hope to have achieved Net Zero emissions throughout the entire production chain and from localized actions we're already on target with our company CO<sub>2</sub> emissions falling 10% annually since 2016.

Our eco-conscious attitude doesn't stop with emissions; we're forever evolving our manufacturing processes to reduce impact on the environment and lead by example.

## Resources

59% of electric consumption in 2022 came from renewable energy, 6% of which was created by solar energy generated on Franke owned sites.

Water consumption decreased by 18.6% in 2022.

Franke Group's consumption of natural gas reduced by 17.5% in 2022.

## Nurturing our people and society

The health of our people and communities is just as important as our planet. That's why we provide leadership training courses throughout our company and aim to make this available for every employee by 2030. We also partner with national and international organizations, volunteering where possible in support of social issues.

**“ We have invested in more solar PV systems, with the capacity to generate around 2,500,000 kWh annually ”**

Patrik Wohlhauser, Franke CEO

## Innovation for sustainable living

Our eco-friendly innovations are designed to empower cleaner living at home and inspire everyday wellbeing.

### Taps

Stainless steel models are made of 100% recyclable steel. The Franke Vital Tap filtration system filters water directly from the tap reducing need for bottled water. Atlas Neo Sensor reduces water waste by up to 50% thanks to the Start/Stop-motion sensor.



### Sinks

Franke's sinks ranges are exemplary in terms of usage of sustainable materials such as stainless steel, Fraganite and ceramic that guarantee extraordinary product durability, resistance and long-lasting quality.



### Hoods

All models are designed to reduce energy consumption and improve energy use with AUTO Functions made to automatically save energy. Class A++ hoods reduce energy consumption up to 85%. Long lasting filters and activated carbon ceramic filters can be regenerated and are designed to further reduce waste compared to standard disposable carbon filters.



### Hob extractors

Our extractor hobs offer maximum energy efficiency. For example, the extremely powerful Mythos 2gether extractor hob is classed in the best possible energy efficiency rating A+++ thanks to its brushless motor.



### Ovens and microwaves

With A and A+ energy ratings offering multi functions that enable different foods to be cooked in one cycle, and a steam cleaning function that allows cleaning without the need of using harmful chemicals.



### Refrigerators

Designed with cold zone compartments to ensure food stays fresher for longer, No Frost technology to help prevent defrosting, and Vacation mode which allows you to keep the freezer compartment active when the fridge isn't.





# FRANKE



# HOME SOLUTIONS

## Solutions that work together

Our kitchens are places to live: we cook there, eat there, spend time together there, more often than not all at the same time. We thoroughly observed the movements we make in our kitchens and developed proper home solutions rather than simple appliances.

Our single products all merge together in functional systems aimed to facilitate your life and please your eye thanks to perfectly matching colours, designs and combinations. When everything comes together, it is easier to enjoy every moment.

## Food preparation areas

**Taps, sinks and waste management systems.**

Award-winning, smart, eco-friendly taps perfectly completed by elegant, spacious bowls that can be equipped with accessories or other smart tools so you have everything you need, always at hand. Everything in the best, most durable and hygienic materials, for example stainless steel or our exclusive Fragranite.



## Hoods

**Wall, ceiling, built-in, island hoods.**

Every kitchen has specific needs, so we created a range of hoods able to surprise you with technology, efficiency, lighting and beautiful designs. Discover the available colours, shapes and special technologies from built-in screens to air-purifying systems.

## Appliances

**Ovens, microwaves, hobs, refrigerators and dishwashers.**

When we design our appliances, we do so with your routines in mind, so that we can offer functional solutions that are easy to use, smart in their features and beautiful to look at.





# Inspir

There is no place like home. And there are no two homes alike. The way we cherish our own nest is just as unique as we are, each one with different tastes, preferences, and needs. To help you get inspired and create the kitchen environment of your dreams, and enjoy it every day, we developed three different **families** of products.

Mythos

## A passion for the best

Our most premium range. Technology meets design, while even the smallest details are carefully sought-after. This **family** sets its goal to the highest levels, combining the very essence of functionality with that of beauty.

Maris

## Family in the kitchen

A **family** inspired by families. Cosy and functional, for savouring the heartwarming experience of a **family** get-together. Maris' philosophy is simple: welcome anyone, anytime with the pride and joy of a homemade dinner.

Smart

## Straight to what matters

The simplest things work the best. Essential in its perfection, to jump to what matters the most: bringing joy to your kitchen. A **family** created to fulfill any need and preference.

What will your kitchen look like it's up to you, but whatever your way of bringing joy home, **you can count on us.**

# ations







# Mythos



**Bowl:** Mythos Masterpiece - BXM 110-68 **Tap:** Eos Neo - Pull Down Spray  
**Soap Dispenser:** Atlas



# Mythos



**Bowl:** Kubus 2 - KNG 110-62  
**Tap:** Icon Doccia



# Mythos



**Bowl:** Mythos - MYX 210-70 **Accessory:** Rollamatt  
**Tap:** Vital - Semi-Pro **Soap Dispenser:** Atlas



# Maris



**Bowl:** Maris Black Collection - MRG 610-72 TL **Tap:** Active - Pull Out Spray  
**Soap Dispenser:** Active





# Maris



**Bowl:** Maris - MRX 210-70  
**Tap:** Active - Swivel Spout







# Smart



**Bowl:** Sirius 2.0 - S2D 611  
**Tap:** Lina - Swivel Spout



# Show what you're made of!

Shiny or matte; smooth or stone-like, extra-strong or super trendy. Your kitchen can speak volumes about you, so every detail counts. To offer you the chance to create your very own perfect kitchen, our range of materials is designed to please any taste, match any style and resist any endeavor. Discover each material's precision-engineered character and unique benefits to choose the one that suits your needs the best and you like the most.

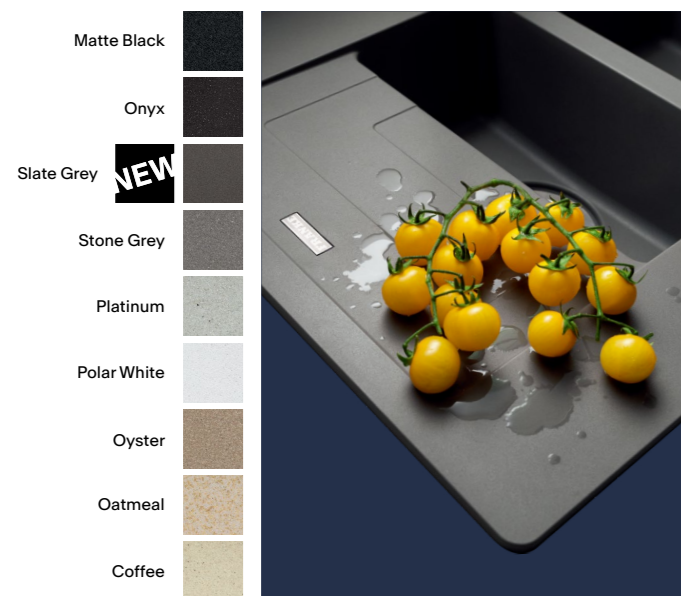

## Fragranite

An exceptionally tough material, highly resistant to burns, dents, chips and stains. Pioneered by Franke, it's a unique material with a subtle sheen that is warm to the touch thanks to its up to 80% of granite. Also, Fragranite treated with Sanitized® reduces bacteria and microbe growth by 99%. A more than relevant feature for our kitchens, as bacteria can multiply every 20 minutes making the kitchen's surfaces highly unhygienic. Available in Slate Grey colour from 2024.



## Stainless Steel

Whether you prefer the more reflective qualities of the polished finish or the more subtle look of the silk or brushed finishes, which give a more matt sheen, there is a Stainless Steel solution for you. Any Franke Stainless Steel product is made from premium quality chrome nickel steel, which looks stunning and is highly resistant to staining, rust and corrosion - plus it won't chip, craze, flake, or break. If Stainless Steel is one of the most popular materials in the kitchen, it's for good reason.

## F-Inox Technology

An exclusive Franke coating able to group water molecules and allowing you to dry your sink without ring stains. Water repellent and scratch-resistant, this futuristic coating also fears no heat up to 350°. A real and long-lasting beauty formula that you can appreciate from our Masterpiece family.



## PVD Coating

PVD, standing for 'Physical Vapor Deposition', is a coating technology that makes tapware even more resistant to abrasions, scratches and corrosion and offers exceptional aesthetic features as well. A tap treated with a PDV coating even resists UV rays and makes fingerprints less visible in a busy kitchen. Available in different finishes, with chrome remaining the most popular, there are now an array of other stunning finishes to choose from. From solid stainless steel, which combines beauty with durability, brass and gunmetal to Industrial Black, Copper and Gold, you really can find something to suit every style of kitchen.





# Innovation is in our DNA

We have always been passionate innovators since our beginnings.

Staying at the forefront of the industry, we keep our range always evolving to include the very highest levels of form and function. By continually applying innovative manufacturing techniques and new materials, we brought our customers classic products and breakthrough technologies. Hence, many of our products received awards for innovation and design such as iF Design Awards, Red Dot Awards, Kitchen Innovation of the Year Award in Germany, etc. It is further testament to our passion for successful design, intelligent functionality and outstanding quality.



## Mythos Masterpiece Collection

iF Design Award 2023, Red Dot Award 2023,  
Kitchen Innovation Award 2023, Kitchen Innovation Golden Award 2023



## Maris Fragranite Sinks

Red Dot Award 2022



## Active Twist & Kubus 2 Matt Black Combination

"Best of the Best" Red Dot Award 2022



## Mythos Bowls

iF Design Award 2020, Red Dot Award 2020



## All-In Food Preparation System

iF Design Award 2023, Red Dot Award 2022,  
Kitchen Innovation Award 2022,  
Kitchen Innovation Golden Award 2022



## Icon Taps

iF Design Award 2021, Red Dot Award 2021



## Box Center

iF Design Award 2019







# Sink

## Overview

### **Kitchen Sinks That Feel Tailor-Made**

Everyone has a different vision of what would make their kitchen wonderful, and that often begins with how they intend to use it. The demands on your sink will dictate which material is right for your kitchen, as each precision-engineered material has individual character and unique benefits.

Our range covers everything, from the new trends to traditional favourites. All you have to do is pick the one that best complements your cooking style, your lifestyle and your personal style.



# Highlights

Details that make the difference



Small details such as minute material processes, its forming history, or an innovative Fast-In installation system make a huge difference in the finished product. Whether it's to save you time, make cleaning easier, boost performance or simply provide an efficient solution for life's little challenges, every aspect of a Franke sink is carefully designed to make life more seamless.

## Choosing Your Perfect Sink



There are a number of considerations to take into account when choosing a sink. Not only how it'll accentuate the overall look and feel of your kitchen, but also how well its installation and functionality work for your lifestyle.

### 1. Material Options

- STAINLESS STEEL
- FRAGRANITE

### 2. Installation Type\*

- INSET
- FLUSHMOUNT
- UNDERMOUNT

### 3. Number of Bowls

- **SINGLE BOWL**  
Single bowl sinks come in a variety of sizes, ideal for limited space or large spaces.
- **DOUBLE BOWL**  
Double bowl sinks offer great flexibility in the kitchen, providing more space, with additional options.

### 4. Cabinet size

The length and depth of the cabinet, on top of which the sink will be located, are the factors that determine the maximum size of an installed sink.

### 5. Bowl depth

A deeper bowl can make it easier to handle large pots and cookware, but the user's height should also be considered. A shallower bowl may provide greater comfort while working in and reaching the bottom of the sink.

### Installation Type\*



 **INSET** the most popular installation option: practical and easy.

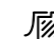

 **FLUSHMOUNT** a sophisticated design that enhances the look of the worktop.



 **UNDERMOUNT** an original, refined installation choice that allows bowls and sinks to be installed underneath marble or synthetic worktops, creating a surface with immaculate lines which is highly functional, elegant and easy to maintain.



# Sinks Overview

## Fragranite Sink



KNG 110-37  
p. 36



KNG 110-52  
p. 36



KNG 120  
p. 36



**NEW**  
MRG 610-37  
p. 37



**NEW**  
MRG 610-52  
p. 37



**NEW**  
MRG 610-62  
p. 37



**NEW**  
MRG 610-72  
p. 38



**NEW**  
MRG 620-35-35  
p. 38



**NEW**  
MRG 610-39 FTL  
p. 38



**NEW**  
MRG 610-54 FTL  
p. 39



**NEW**  
MRG 610-73 FTL  
p. 39



**NEW**  
MRG 620-34-34 FTL  
p. 39



UBG 610-56  
p. 40



UBG 610-78  
p. 40



UBG 620-86  
p. 40

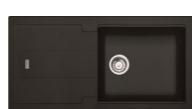

BLG 611-97  
p. 41

## Stainless Steel Sink



MRX 110-34  
p. 44



MRX 110-40  
p. 44



MRX 110-45  
p. 44



MRX 110-50  
p. 45



MRX 110-55  
p. 45



MRX 110-70  
p. 45



MRX 120-34-34  
p. 46



MRX 120-40-40  
p. 46



FEX 110-40  
p. 47



FEX 110-50  
p. 47



FEX 110-60  
p. 47



**NEW**  
FEX 110-70  
p. 48



**NEW**  
FEX 120-40-34 SBL  
p. 48



**NEW**  
FEX 120-40-34 SBR  
p. 48



BXX 210-36  
p. 49



BXX 210-45  
p. 49



BXX 210-50  
p. 49



BXX 210-54  
p. 50



BXX 210-65  
p. 50



BXX 210-72  
p. 50



BXX 260-40  
SBR/SBL  
p. 51



BXX 220-36-36  
p. 51



BXX 220-74  
SBR/SBL  
p. 51



BCX 110-42  
p. 52



BCX 610-51  
p. 52



BCX 610-61  
p. 52



BCX 611-86  
LHD/RHD  
p. 53



BCX 621  
LHD/RHD  
p. 53



BCX 120-35-35  
p. 53



BCX 620-38-32  
p. 54



BCX 620-42-35  
p. 54



LUX 610  
p. 54

MYTHOS

MARIS

SMART



# Fragranite Sink

Durable and versatile, Fragranite offers a host of practical and aesthetic benefits. The surface's rich colour won't stain, mark or fade over time. Plus, having been heated up to 280°C, the material superbly hard-wearing, making it impact and scratch resistant – perfect for busy family homes. What's more, our Fragranite's Sanitized® coating reduces bacteria and microbe growth by 99%, helping keep your sink hygienic and clean.

Superbly hard-wearing, sinks made of granite are particularly elegant and bring a natural look into your kitchen.

Our processed granite has a subtle shine and feels warm to the touch. The surface is finely textured but not porous, ensuring a high standard of hygiene.

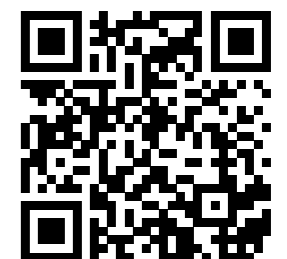



FRAGRANITE SINK

MYTHOS



**Overall Size** 410 x 460mm (LxW)  
**Bowl Size** 370 x 420 x 200mm (LxWxD)  
**Cut-out Size** 370 x 420mm, R10 (LxW)  
**Installation** Undermount  
**Included Accessory**  
 Waste kit w/ overflow



reddot design award  
winner 2019

**SLOVAKIA**



**Model**  
 Kubus 2 KNG 110-37  
 Onyx  
**Suggested Retail Price**  
**\$5,380**



Optional Accessory

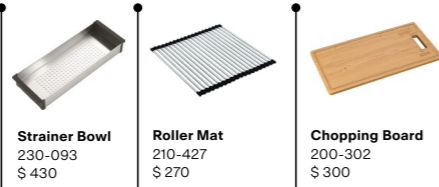

**Strainer Bowl**  
230-093  
\$ 430

**Roller Mat**  
210-427  
\$ 270

**Chopping Board**  
200-302  
\$ 300

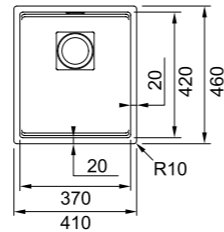

MYTHOS



**Overall Size** 560 x 460mm (LxW)  
**Bowl Size** 520 x 420 x 200mm (LxWxD)  
**Cut-out Size** 520 x 420mm, R10 (LxW)  
**Installation** Undermount  
**Included Accessory**  
 Waste kit w/ overflow



reddot design award  
winner 2019

**SLOVAKIA**



**Model**  
 Kubus 2 KNG 110-52  
 Stone Grey  
**Suggested Retail Price**  
**\$6,180**



Optional Accessory

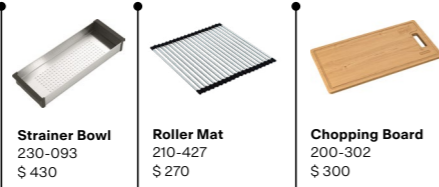

**Strainer Bowl**  
230-093  
\$ 430

**Roller Mat**  
210-427  
\$ 270

**Chopping Board**  
200-302  
\$ 300

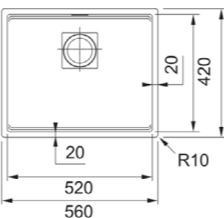

MYTHOS



**Overall Size** 760 x 460mm (LxW)  
**Bowl Size** 460 x 420 x 200mm (LxWxD),  
 210 x 420 x 200mm (LxWxD)  
**Cut-out Size** 720 x 420mm, R10 (LxW)  
**Installation** Undermount  
**Included Accessory**  
 Waste kit w/ overflow



reddot design award  
winner 2019

**SLOVAKIA**



**Model**  
 Kubus 2 KNG 120  
 Polar White  
**Suggested Retail Price**  
**\$6,680**



Optional Accessory

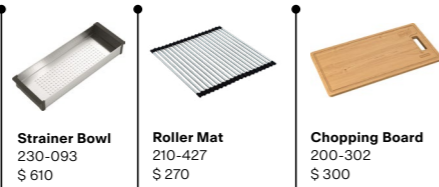

**Strainer Bowl**  
230-093  
\$ 610

**Roller Mat**  
210-427  
\$ 270

**Chopping Board**  
200-302  
\$ 300

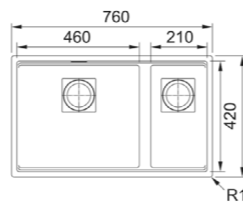

FRAGRANITE SINK

MARIS



**Overall Size** 410 x 440mm (LxW)  
**Bowl Size** 371 x 401 x 200mm (LxWxD)  
**Cut-out Size** 390 x 428mm, R15 (LxW)  
**Installation** Inset, undermount  
**Included Accessory**  
 Waste kit w/ overflow



reddot design award  
winner 2022

**SLOVAKIA**

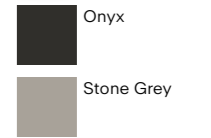

NEW



**Model**  
 Maris MRG 610-37  
 Onyx  
**Suggested Retail Price**  
**\$4,780**

Optional Accessory

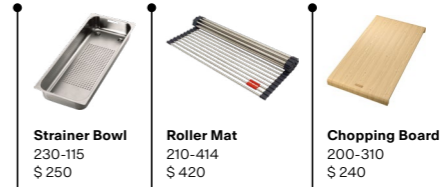

**Strainer Bowl**  
230-115  
\$ 250

**Roller Mat**  
210-414  
\$ 420

**Chopping Board**  
200-310  
\$ 240

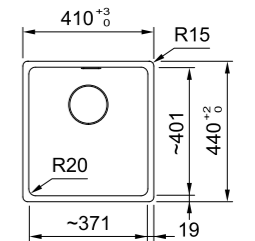

MARIS



**Overall Size** 560 x 440mm (LxW)  
**Bowl Size** 521 x 401 x 200mm (LxWxD)  
**Cut-out Size** 540 x 428mm, R15 (LxW)  
**Installation** Inset, undermount  
**Included Accessory**  
 Waste kit w/ overflow



reddot design award  
winner 2022

**SLOVAKIA**

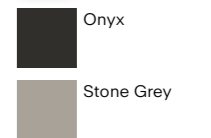

NEW



**Model**  
 Maris MRG 610-52  
 Stone Grey  
**Suggested Retail Price**  
**\$5,080**

Optional Accessory

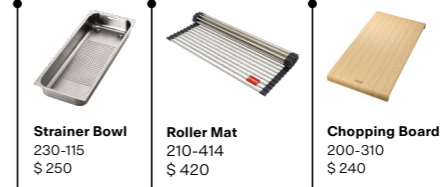

**Strainer Bowl**  
230-115  
\$ 250

**Roller Mat**  
210-414  
\$ 420

**Chopping Board**  
200-310  
\$ 240

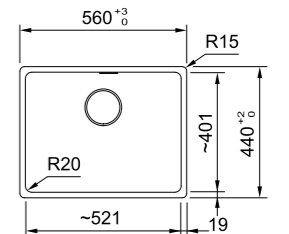

MARIS



**Overall Size** 660 x 440mm (LxW)  
**Bowl Size** 621 x 401 x 200mm (LxWxD)  
**Cut-out Size** 640 x 428mm, R15 (LxW)  
**Installation** Inset, undermount  
**Included Accessory**  
 Waste kit w/ overflow



reddot design award  
winner 2022

**SLOVAKIA**



NEW



**Model**  
 Maris MRG 610-62  
 Onyx  
**Suggested Retail Price**  
**\$5,280**

Optional Accessory

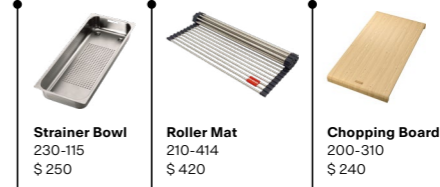

**Strainer Bowl**  
230-115  
\$ 250

**Roller Mat**  
210-414  
\$ 420

**Chopping Board**  
200-310  
\$ 240

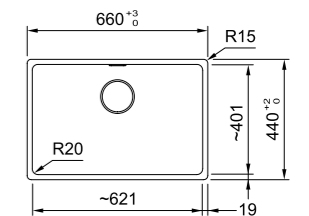



FRAGRANITE SINK

MARIS



**Overall Size** 760 x 440mm (LxW)  
**Bowl Size** 720 x 401 x 200mm (LxWxD)  
**Cut-out Size** 740 x 428mm, R15 (LxW)  
**Installation** Inset, undermount  
**Included Accessory**  
 Waste kit w/ overflow



NEW

**Model**  
 Maris MRG 610-72  
 Stone Grey  
**Suggested Retail Price**  
**\$5,480**

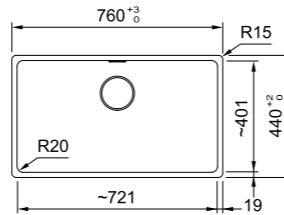

MARIS



**Overall Size** 760 x 440mm (LxW)  
**Bowl Size** 346 x 401 x 200mm (LxWxD)  
 347 x 401 x 200mm (LxWxD)  
**Cut-out Size** 740 x 428mm, R15 (LxW)  
**Installation** Inset, undermount  
**Included Accessory**  
 Waste kit w/ overflow

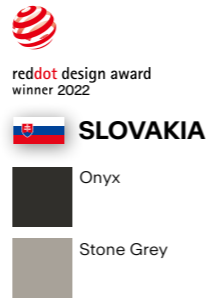

NEW

**Model**  
 Maris MRG 620-35-35  
 Onyx  
**Suggested Retail Price**  
**\$5,980**

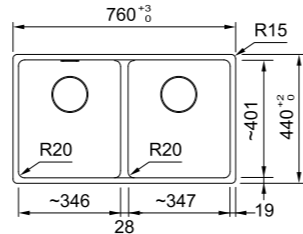
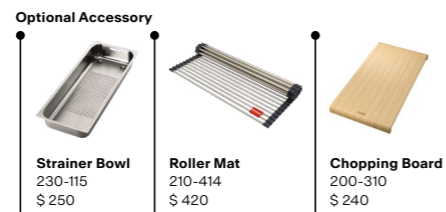

MARIS



**Overall Size** 440 x 500mm (LxW)  
**Bowl Size** 391 x 400 x 200mm (LxWxD)  
**Cut-out Size** 420 x 480mm, R15 (LxW)  
**Installation** Inset  
**Included Accessory**  
 Waste kit w/ overflow

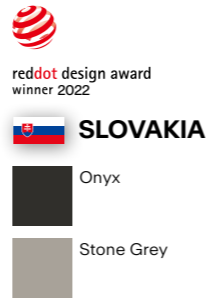

NEW

**Model**  
 Maris MRG 610-39  
 FTL Stone Grey  
**Suggested Retail Price**  
**\$4,880**

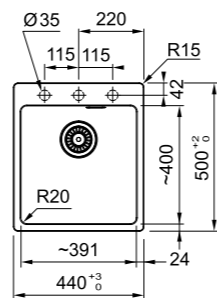
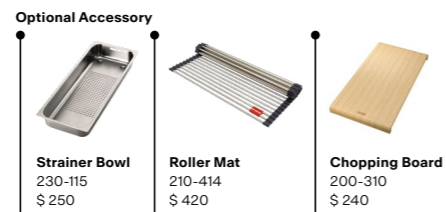

FRAGRANITE SINK

MARIS



**Overall Size** 590 x 500mm (LxW)  
**Bowl Size** 541 x 400 x 200mm (LxWxD)  
**Cut-out Size** 570 x 480mm, R15 (LxW)  
**Installation** Inset  
**Included Accessory**  
 Waste kit w/ overflow



NEW

**Model**  
 Maris MRG 610-54  
 FTL Onyx  
**Suggested Retail Price**  
**\$5,180**

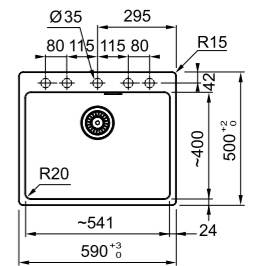
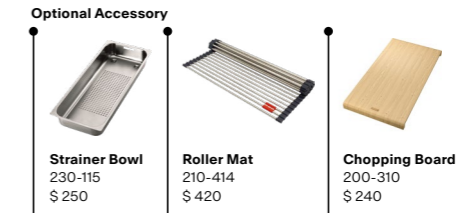

MARIS



**Overall Size** 780 x 500mm (LxW)  
**Bowl Size** 731 x 400 x 200mm (LxWxD)  
**Cut-out Size** 760 x 480mm, R15 (LxW)  
**Installation** Inset  
**Included Accessory**  
 Waste kit w/ overflow



NEW

**Model**  
 Maris MRG 610-73 FTL  
 Stone Grey  
**Suggested Retail Price**  
**\$5,580**

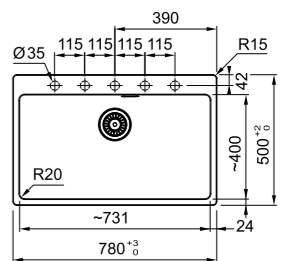
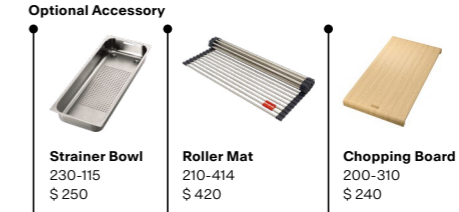

MARIS



**Overall Size** 760 x 500mm (LxW)  
**Bowl Size** 340 x 400 x 200mm (LxWxD),  
 340 x 400 x 200mm (LxWxD)  
**Cut-out Size** 740 x 480mm, R15 (LxW)  
**Installation** Inset  
**Included Accessory**  
 Waste kit w/ overflow



NEW

**Model**  
 Maris MRG 620-34-34 FTL  
 Onyx  
**Suggested Retail Price**  
**\$6,080**

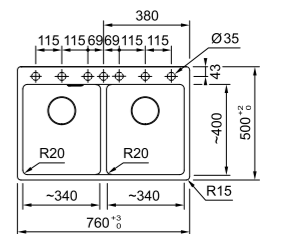
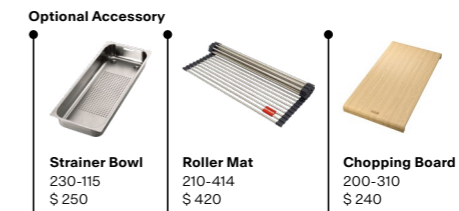



FRAGRANITE SINK

MARIS



**Overall Size** 560 x 500mm (LxW)  
**Bowl Size** 503 x 425 x 230mm (LxWxD)  
**Cut-out Size** 540 x 480mm, R15 (LxW)  
**Installation** Inset  
**Included Accessory**  
 Waste kit w/ overflow, strainer bowl

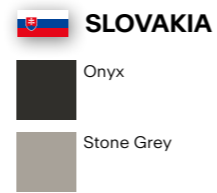

**Model**  
 Urban UBG 610-56  
 Onyx  
**Suggested Retail Price**  
**\$4,780**

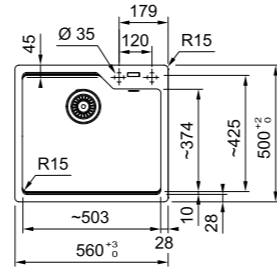

FRAGRANITE SINK

MARIS



**Overall Size** 970 x 500mm (LxW)  
**Bowl Size** 460 x 390 x 190mm (LxWxD)  
**Cut-out Size** 950 x 480mm, R22 (LxW)  
**Installation** Inset  
**Included Accessory**  
 Waste kit w/ overflow

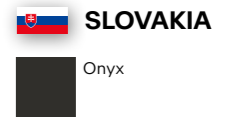

**Model**  
 Bali BLG 611-97  
 Onyx  
**Suggested Retail Price**  
**\$5,680**

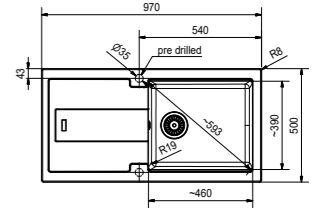

MARIS



**Overall Size** 780 x 500mm (LxW)  
**Bowl Size** 724 x 425 x 230mm (LxWxD)  
**Cut-out Size** 760 x 480mm, R15 (LxW)  
**Installation** Inset  
**Included Accessory**  
 Waste kit w/ overflow, strainer bowl

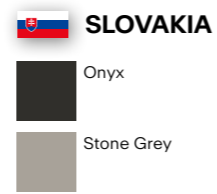

**Model**  
 Urban UBG 610-78  
 Stone Grey  
**Suggested Retail Price**  
**\$5,280**

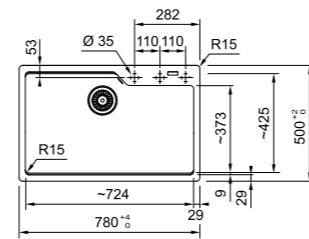

MARIS



**Overall Size** 860 x 500mm (LxW)  
**Bowl Size** 432 x 425 x 230mm (LxWxD),  
 341 x 364 x 220mm (LxWxD)  
**Cut-out Size** 840 x 480mm, R15 (LxW)  
**Installation** Inset  
**Included Accessory**  
 Waste kit w/ overflow, strainer bowl

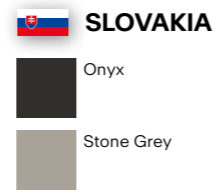

**Model**  
 Urban UBG 620-86  
 Onyx  
**Suggested Retail Price**  
**\$5,580**

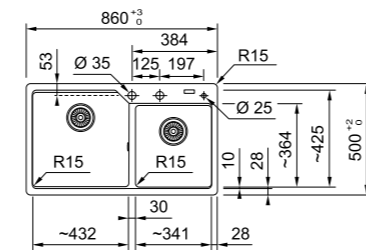
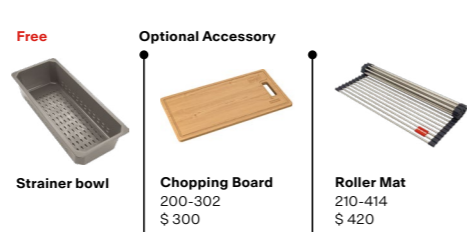





# Stainless Steel Sink

Franke stainless steel sinks are made from premium quality 304 stainless chrome nickel steel. Stunningly beautiful, highly resistant to stains, rust and corrosion - plus, it won't chip, craze, flake or break.

Franke offers sinks in a selection of stainless steel finishes, so whether you prefer the more reflective qualities of a polished finish or the subtle matt sheen of a silk or brushed finish, there's a stainless steel solution for you.

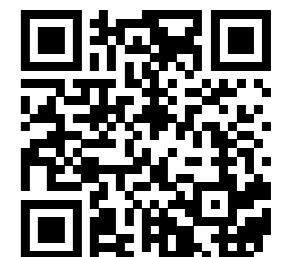



STAINLESS STEEL SINK

MARIS



**Radius** 16  
**Thickness** 0.8mm  
**Overall Size** 380 x 440mm (LxW)  
**Bowl Size** 340 x 400 x 180mm (LxWxD)  
**Cut-out Size** 340 x 400mm, R16 (LxW)  
**Installation** Undermount  
**Included Accessory**  
 Waste kit w/ overflow

SWITZERLAND

**Model**  
 Maris MRX 110-34  
**Suggested Retail Price**  
**\$3,280**

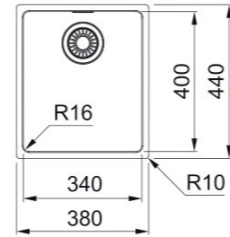

STAINLESS STEEL SINK

MARIS



**Radius** 16  
**Thickness** 0.8mm  
**Overall Size** 540 x 440mm (LxW)  
**Bowl Size** 500 x 400 x 180mm (LxWxD)  
**Cut-out Size** 500 x 400mm, R16 (LxW)  
**Installation** Undermount  
**Included Accessory**  
 Waste kit w/ overflow

SWITZERLAND

**Model**  
 Maris MRX 110-50  
**Suggested Retail Price**  
**\$3,680**

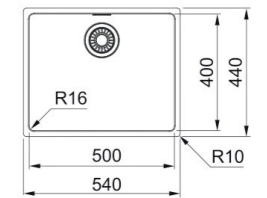

MARIS



**Radius** 16  
**Thickness** 0.8mm  
**Overall Size** 440 x 440mm (LxW)  
**Bowl Size** 400 x 400 x 180mm (LxWxD)  
**Cut-out Size** 400 x 400mm, R16 (LxW)  
**Installation** Undermount  
**Included Accessory**  
 Waste kit w/ overflow

SWITZERLAND

**Model**  
 Maris MRX 110-40  
**Suggested Retail Price**  
**\$3,380**

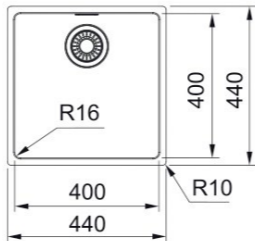
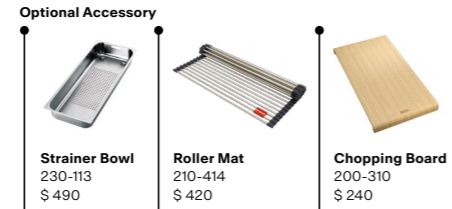

MARIS



**Radius** 16  
**Thickness** 0.8mm  
**Overall Size** 590 x 440mm (LxW)  
**Bowl Size** 550 x 400 x 180mm (LxWxD)  
**Cut-out Size** 550 x 400mm, R16 (LxW)  
**Installation** Undermount  
**Included Accessory**  
 Waste kit w/ overflow

SWITZERLAND

**Model**  
 Maris MRX 110-55  
**Suggested Retail Price**  
**\$3,880**

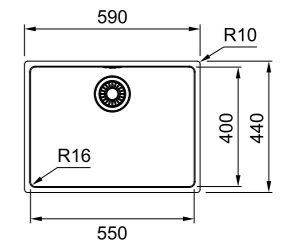
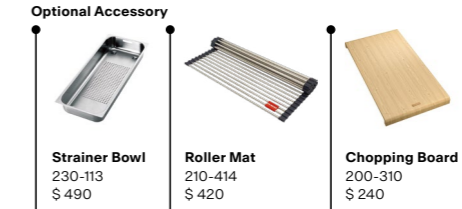

MARIS



**Radius** 16  
**Thickness** 0.8mm  
**Overall Size** 490 x 440mm (LxW)  
**Bowl Size** 450 x 400 x 180mm (LxWxD)  
**Cut-out Size** 450 x 400mm, R16 (LxW)  
**Installation** Undermount  
**Included Accessory**  
 Waste kit w/ overflow

SWITZERLAND

**Model**  
 Maris MRX 110-45  
**Suggested Retail Price**  
**\$3,480**

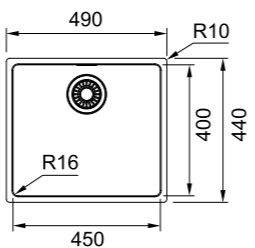
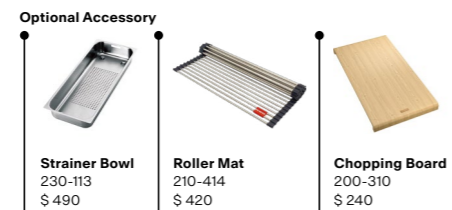

MARIS



**Radius** 16  
**Thickness** 0.8mm  
**Overall Size** 740 x 440mm (LxW)  
**Bowl Size** 700 x 400 x 180mm (LxWxD)  
**Cut-out Size** 700 x 400mm, R16 (LxW)  
**Installation** Undermount  
**Included Accessory**  
 Waste kit w/ overflow

SWITZERLAND

**Model**  
 Maris MRX 110-70  
**Suggested Retail Price**  
**\$4,680**

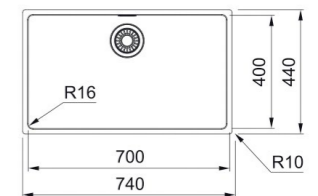
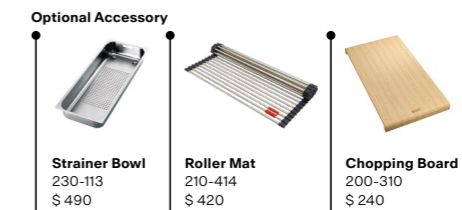



STAINLESS STEEL SINK

MARIS



**Radius** 16  
**Thickness** 0.8mm  
**Overall Size** 745 x 440mm (LxW)  
**Bowl Size** 340 x 400 x 180mm (LxWxD),  
 340 x 400 x 180mm (LxWxD)  
**Cut-out Size** 705 x 400mm, R16 (LxW)  
**Installation** Undermount  
**Included Accessory**  
 Waste kit w/ overflow

SWITZERLAND

**Model**  
 Maris MRX 120-34-34  
**Suggested Retail Price**  
**\$6,780**

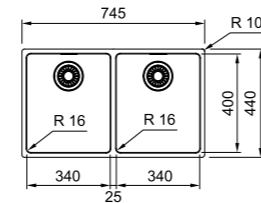
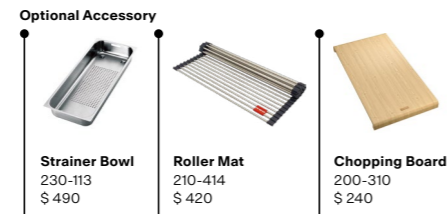

MARIS



**Radius** 16  
**Thickness** 0.8mm  
**Overall Size** 865 x 440mm (LxW)  
**Bowl Size** 400 x 400 x 180mm (LxWxD),  
 400 x 400 x 180mm (LxWxD)  
**Cut-out Size** 825 x 400mm, R16 (LxW)  
**Installation** Undermount  
**Included Accessory**  
 Waste kit w/ overflow

SWITZERLAND

**Model**  
 Maris MRX 120-40-40  
**Suggested Retail Price**  
**\$6,880**

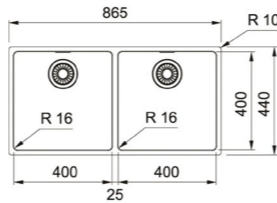
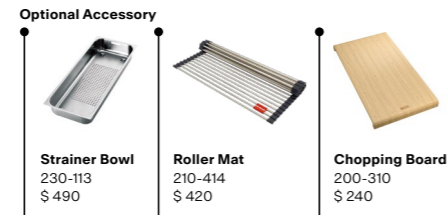

STAINLESS STEEL SINK

MARIS



**Radius** 16  
**Thickness** 1.0mm  
**Overall Size** 440 x 440 x 200mm (LxWxD)  
**Bowl Size** 400 x 400 x 200mm (LxWxD)  
**Installation** Flushmount, undermount  
**Included Accessory**  
 Waste kit w/ overflow

**Model**  
 Flex FEX 110-40  
**Suggested Retail Price**  
**\$2,880**

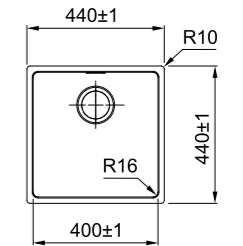
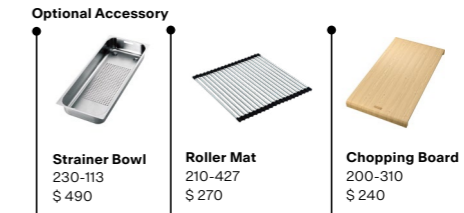

MARIS



**Radius** 16  
**Thickness** 1.0mm  
**Overall Size** 540 x 440 x 200mm (LxWxD)  
**Bowl Size** 500 x 400 x 200mm (LxWxD)  
**Installation** Flushmount, undermount  
**Included Accessory**  
 Waste kit w/ overflow

**Model**  
 Flex FEX 110-50  
**Suggested Retail Price**  
**\$2,980**

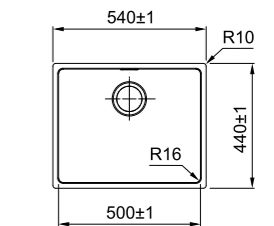
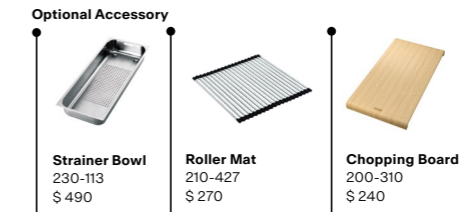

MARIS



**Radius** 16  
**Thickness** 1.0mm  
**Overall Size** 640 x 440 x 200mm (LxWxD)  
**Bowl Size** 600 x 400 x 200mm (LxWxD)  
**Installation** Flushmount, undermount  
**Included Accessory**  
 Waste kit w/ overflow

**Model**  
 Flex FEX 110-60  
**Suggested Retail Price**  
**\$3,180**

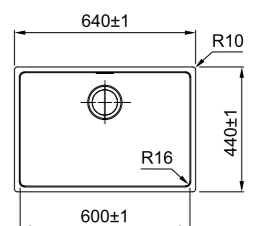
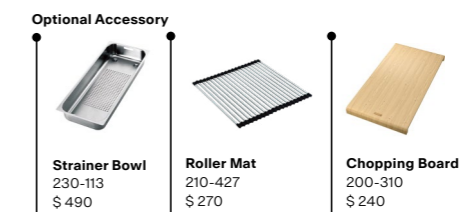



STAINLESS STEEL SINK

MARIS



**Radius** 16  
**Thickness** 1.0mm  
**Overall Size** 740 x 440 x 200mm (LxWxD)  
**Bowl Size** 700 x 400 x 200mm (LxWxD)  
**Installation** Flushmount, undermount  
**Included Accessory**  
 Waste kit w/ overflow

NEW

**Model**  
 Flex FEX 110-70  
**Suggested Retail Price**  
**\$3,580**

Optional Accessory

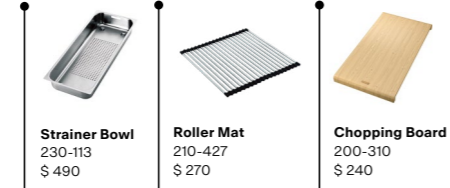

**Strainer Bowl**  
 230-113  
 \$ 490

**Roller Mat**  
 210-427  
 \$ 270

**Chopping Board**  
 200-310  
 \$ 240

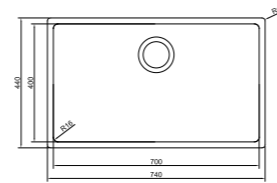

MARIS



**Radius** 16  
**Thickness** 1.0mm  
**Overall Size** 800 x 440 x 200mm (LxWxD)  
**Bowl Size** 340 x 400 x 200mm (LxWxD),  
 400 x 400 x 200mm (LxWxD)  
**Installation** Flushmount, undermount  
**Included Accessory**  
 Waste kit w/ overflow

NEW

**Model**  
 Flex FEX 120-40-34 SBL  
**Suggested Retail Price**  
**\$4,480**

Optional Accessory

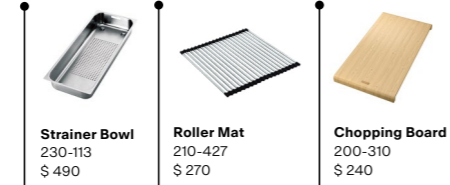

**Strainer Bowl**  
 230-113  
 \$ 490

**Roller Mat**  
 210-427  
 \$ 270

**Chopping Board**  
 200-310  
 \$ 240

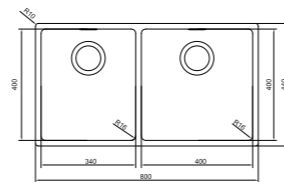

MARIS



**Radius** 16  
**Thickness** 1.0mm  
**Overall Size** 800 x 440 x 200mm (LxWxD)  
**Bowl Size** 400 x 400 x 200mm (LxWxD),  
 340 x 400 x 200mm (LxWxD)  
**Installation** Flushmount, undermount  
**Included Accessory**  
 Waste kit w/ overflow

NEW

**Model**  
 Flex FEX 120-40-34 SBR  
**Suggested Retail Price**  
**\$4,480**

Optional Accessory

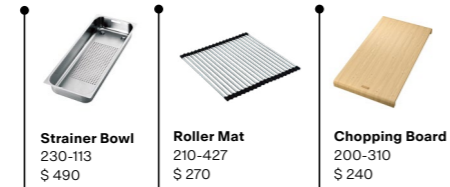

**Strainer Bowl**  
 230-113  
 \$ 490

**Roller Mat**  
 210-427  
 \$ 270

**Chopping Board**  
 200-310  
 \$ 240

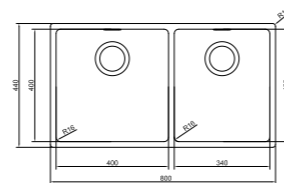

STAINLESS STEEL SINK

MARIS



**Radius** 12  
**Thickness** 1.2mm  
**Overall Size** 400 x 450 x 200mm (LxWxD)  
**Bowl Size** 360 x 410 x 200mm (LxWxD)  
**Cut-out Size** 370 x 420mm (LxW)  
**Installation** Inset, flushmount, undermount  
**Included Accessory**  
 Waste kit w/ overflow



**Model**  
 Box BXX 210-36  
**Suggested Retail Price**  
**\$2,380**

Optional Accessory



**Strainer Bowl**  
 230-093  
 \$ 430

**Roller Mat**  
 210-414  
 \$ 420

**Chopping Board**  
 200-292  
 \$ 160

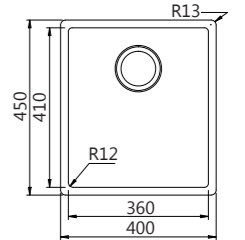

MARIS



**Radius** 12  
**Thickness** 1.2mm  
**Overall Size** 490 x 450 x 200mm (LxWxD)  
**Bowl Size** 450 x 410 x 200mm (LxWxD)  
**Cut-out Size** 460 x 420mm (LxW)  
**Installation** Inset, flushmount, undermount  
**Included Accessory**  
 Waste kit w/ overflow



**Model**  
 Box BXX 210-45  
**Suggested Retail Price**  
**\$2,480**

Optional Accessory



**Strainer Bowl**  
 230-093  
 \$ 430

**Roller Mat**  
 210-414  
 \$ 420

**Chopping Board**  
 200-292  
 \$ 160

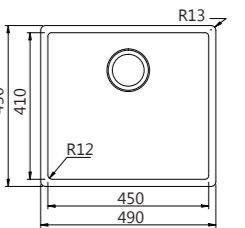

MARIS



**Radius** 12  
**Thickness** 1mm  
**Overall Size** 540 x 450 x 200mm (LxWxD)  
**Bowl Size** 500 x 410 x 200mm (LxWxD)  
**Cut-out Size** 510 x 420mm (LxW)  
**Installation** Inset, flushmount, undermount  
**Included Accessory**  
 Waste kit w/ overflow



**Model**  
 Box BXX 210-50  
**Suggested Retail Price**  
**\$2,580**

Optional Accessory

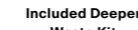

**Strainer Bowl**  
 230-093  
 \$ 430

**Roller Mat**  
 210-414  
 \$ 420

**Chopping Board**  
 200-292  
 \$ 160

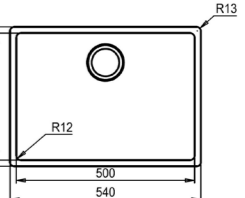



STAINLESS STEEL SINK

MARIS



**Radius** 12  
**Thickness** 1.2mm  
**Overall Size** 580 x 450 x 200mm (LxWxD)  
**Bowl Size** 540 x 410 x 200mm (LxWxD)  
**Cut-out Size** 550 x 420mm (LxW)  
**Installation** Inset, flushmount, undermount  
**Included Accessory**  
 Waste kit w/ overflow



**Model**  
 Box BXX 210-54  
**Suggested Retail Price**  
**\$2,680**



Optional Accessory

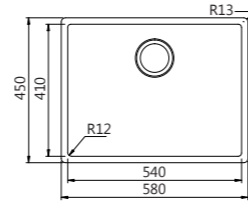
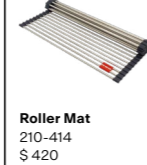
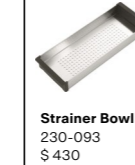

STAINLESS STEEL SINK

MARIS



**Radius** 12  
**Thickness** 1.2mm  
**Overall Size** 662 x 450 x 200mm (LxWxD)  
**Bowl Size** 400 x 410 x 200mm (LxWxD),  
 200 x 410 x 200mm (LxWxD)  
**Cut-out Size** 632 x 420mm (LxW)  
**Installation** Inset, flushmount, undermount  
**Included Accessory**  
 Waste kit w/ overflow



**Model**  
 Box BXX 260-40  
 SBR / SBL  
**Suggested Retail Price**  
**\$4,680**



Optional Accessory

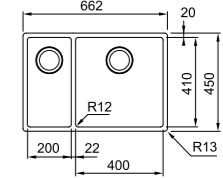
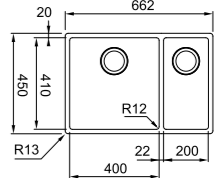
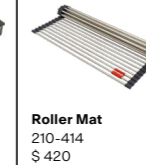
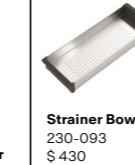

MARIS



**Radius** 12  
**Thickness** 1.2mm  
**Overall Size** 690 x 450 x 200mm (LxWxD)  
**Bowl Size** 650 x 410 x 200mm (LxWxD)  
**Cut-out Size** 660 x 420mm (LxW)  
**Installation** Inset, flushmount, undermount  
**Included Accessory**  
 Waste kit w/ overflow



**Model**  
 Box BXX 210-65  
**Suggested Retail Price**  
**\$3,080**



Optional Accessory

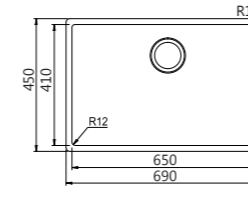
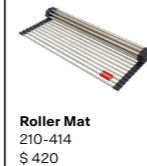
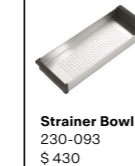

MARIS



**Radius** 12  
**Thickness** 1.2mm  
**Overall Size** 782 x 450 x 200mm (LxWxD)  
**Bowl Size** 360 x 410 x 200mm (LxWxD),  
 360 x 410 x 200mm (LxWxD)  
**Cut-out Size** 752 x 420mm (LxW)  
**Installation** Inset, flushmount, undermount  
**Included Accessory**  
 Waste kit w/ overflow



**Model**  
 Box BXX 220-36-36  
**Suggested Retail Price**  
**\$4,980**



Optional Accessory

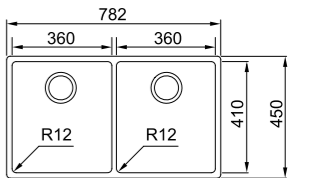
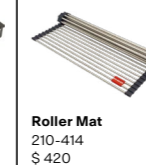

MARIS



**Radius** 12  
**Thickness** 1.2mm  
**Overall Size** 760 x 450 x 200mm (LxWxD)  
**Bowl Size** 720 x 410 x 200mm (LxWxD)  
**Cut-out Size** 730 x 420mm (LxW)  
**Installation** Inset, flushmount, undermount  
**Included Accessory**  
 Waste kit w/ overflow



**Model**  
 Box BXX 210-72  
**Suggested Retail Price**  
**\$3,480**



Optional Accessory

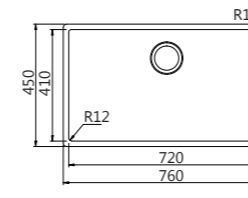
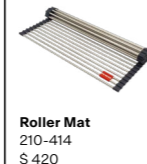
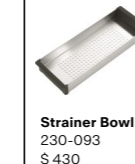

MARIS



**Radius** 12  
**Thickness** 1.2mm  
**Overall Size** 780 x 450 x 200mm (LxWxD)  
**Bowl Size** 420 x 410 x 200mm (LxWxD),  
 298 x 410 x 200mm (LxWxD)  
**Cut-out Size** 730 x 420mm (LxW)  
**Installation** Inset, flushmount, undermount  
**Included Accessory**  
 Waste kit w/ overflow



**Model**  
 Box BXX 220-74  
 SBL / SBR  
**Suggested Retail Price**  
**\$4,980**



Optional Accessory

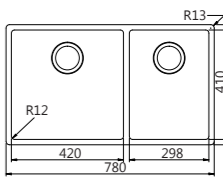
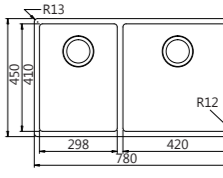
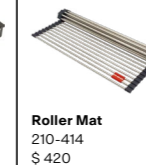
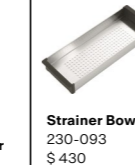



STAINLESS STEEL SINK

SMART



**Radius** 50  
**Thickness** 0.8mm  
**Overall Size** 450 x 445mm (LxW)  
**Bowl Size** 420 x 415 x 200mm (LxWxD)  
**Cut-out Size** 420 x 415mm, R50 (LxW)  
**Installation** Undermount  
**Included Accessory**  
 Waste kit w/ overflow

Optional Accessory



**Strainer Bowl**  
 230-104  
 \$ 50



**Roller Mat**  
 210-414  
 \$ 420

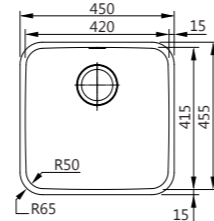

**Model**  
 Bell BCX 110-42  
**Suggested Retail Price**  
**\$1,480**

STAINLESS STEEL SINK

SMART



**Radius** 50  
**Thickness** 0.8mm  
**Overall Size** 860 x 480mm (LxW)  
**Bowl Size** 420 x 415 x 200mm (LxWxD)  
**Cut-out Size** 836 x 456mm, R10 (LxW)  
**Installation** Inset  
**Included Accessory**  
 Waste kit w/ overflow

Optional Accessory



**Strainer Bowl**  
 230-104  
 \$ 50

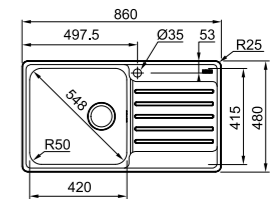
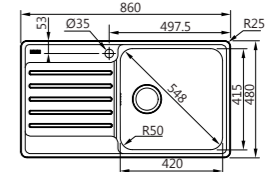

**Model**  
 Bell BCX 611-86  
 LHD / RHD  
**Suggested Retail Price**  
**\$2,280**

SMART



**Radius** 50  
**Thickness** 0.8mm  
**Overall Size** 510 x 510mm (LxW)  
**Bowl Size** 445 x 380 x 200mm (LxWxD)  
**Cut-out Size** 486 x 486mm, R10 (LxW)  
**Installation** Inset  
**Included Accessory**  
 Waste kit w/ overflow

Optional Accessory

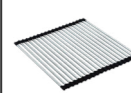

**Roller Mat**  
 210-427  
 \$ 270

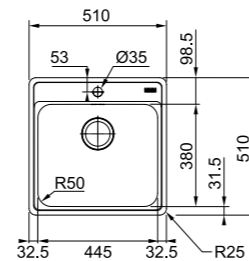

**Model**  
 Bell BCX 610-51  
**Suggested Retail Price**  
**\$1,780**

SMART



**Radius** 50  
**Thickness** 0.8mm  
**Overall Size** 1080 x 480mm (LxW)  
**Bowl Size** 380 x 415 x 180mm (LxWxD),  
 320 x 350 x 160mm (LxWxD)  
**Cut-out Size** 1056 x 456mm, R10 (LxW)  
**Installation** Inset  
**Included Accessory**  
 Waste kit w/ overflow

Optional Accessory



**Strainer Bowl**  
 230-104  
 \$ 50

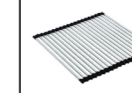

**Roller Mat**  
 210-427  
 \$ 270

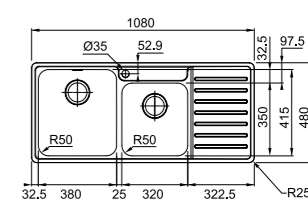
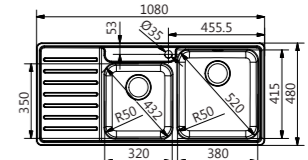

**Model**  
 Bell BCX 621  
 LHD / RHD  
**Suggested Retail Price**  
**\$2,880**

SMART



**Radius** 50  
**Thickness** 0.8mm  
**Overall Size** 610 x 480mm (LxW)  
**Bowl Size** 545 x 415 x 200mm (LxWxD)  
**Cut-out Size** 586 x 456mm, R10 (LxW)  
**Installation** Inset  
**Included Accessory**  
 Waste kit w/ overflow

Optional Accessory



**Roller Mat**  
 210-427  
 \$ 270

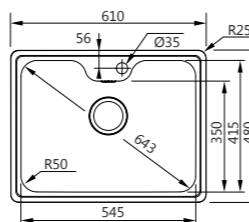

**Model**  
 Bell BCX 610-61  
**Suggested Retail Price**  
**\$1,980**

SMART



**Radius** 50  
**Thickness** 0.8mm  
**Overall Size** 775 x 400mm (LxW)  
**Bowl Size** 350 x 350 x 180mm (LxWxD),  
 350 x 350 x 180mm (LxWxD)  
**Cut-out Size** 725 x 350mm, R50 (LxW)  
**Installation** Undermount  
**Included Accessory**  
 Waste kit w/ overflow

Optional Accessory

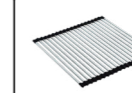

**Roller Mat**  
 210-427  
 \$ 270

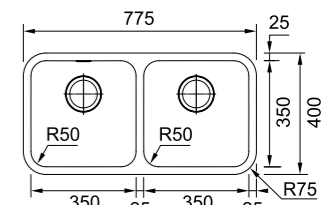

**Model**  
 Bell BCX 120-35-35  
**Suggested Retail Price**  
**\$1,880**



## STAINLESS STEEL SINK

SMART



**Radius** 50

**Thickness** 0.8mm

**Overall Size** 790 x 480mm (LxW)

**Bowl Size** 380 x 415 x 180mm (LxWxD),  
320 x 350 x 160mm (LxWxD)

**Cut-out Size** 766 x 456mm, R10 (LxW)

**Installation** Inset

**Included Accessory**

Waste kit w/ overflow

**Model**

Bell BCX 620-38-32

**Suggested Retail Price**  
**\$2,080**

Optional Accessory



**Strainer Bowl**  
230-104  
\$ 50

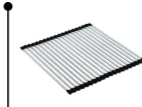

**Roller Mat**  
210-427  
\$ 270

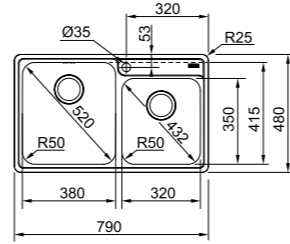

SMART



**Radius** 50

**Thickness** 0.8mm

**Overall Size** 860 x 480mm (LxW)

**Bowl Size** 420 x 415 x 200mm (LxWxD),  
350 x 350 x 180mm (LxWxD)

**Cut-out Size** 836 x 456mm, R10 (LxW)

**Installation** Inset

**Included Accessory**

Waste kit w/ overflow

**Model**

Bell BCX 620-42-35

**Suggested Retail Price**  
**\$2,180**

Optional Accessory



**Strainer Bowl**  
230-104  
\$ 50

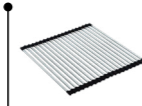

**Roller Mat**  
210-427  
\$ 270

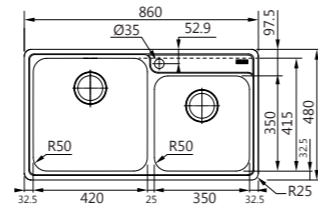

SMART



**Overall Size** ø440 x 180mm (LxD)

**Bowl Size** ø380 x 180mm (LxW)

**Cut-out Size** ø426mm (LxW)

**Installation** Inset

**Included Accessory**

Waste kit w/ overflow

**Model**

Lugano LUX 610

**Suggested Retail Price**  
**\$1,680**

Optional Accessory

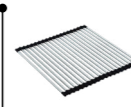

**Roller Mat**  
210-427  
\$ 270

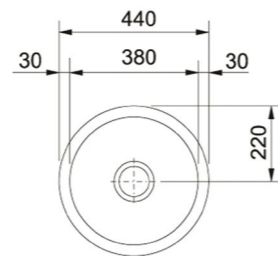





# Accessories

## A seamless supplement to your sink

Turn your sink into a multi-functional work station with the addition of clever accessories that combine function and technology. From items that aid a hygienic kitchen, to those that make preparation a joy, you'll find accessories that surprise and delight, such as the lightboard that fits exactly over the bowl of the sink and acts as an ambient cover.



### The Best-Selling Roller Mat

A Franke classic that's not only useful and versatile, but also adds an elegant look to your sink.



### Wooden Chopping Board

Our Chopping Board fits your sink perfectly, sitting securely over the bowl. Allowing you to maximise workspace and transform your sink into a multi-purpose workstation.



### The Neat Strainer Bowl

A beautiful strainer bowl that simply fits. The anti-scratch frame glides perfectly on the edge of the sink: move it to where you need it.



STRAINER BOWL



**Overall Size** 411 x 172 x 55mm (LxWxH)  
**Bowl Outer Size** 390 x 150mm (LxW)  
**Material** Stainless Steel  
**Applicable Sink Model** MRX



**Model**  
 230-113  
**Suggested Retail Price**  
**\$490**

STRAINER BOWL



**Overall Size** 448 x 177 x 92mm (LxWxH)  
**Bowl Outer Size** 425 x 160mm (LxW)  
**Material** Polypropylene



**Model**  
 230-111  
**Suggested Retail Price**  
**\$270**



**Overall Size** 439 x 156 x 50mm (LxWxH)  
**Bowl Outer Size** 415 x 152mm (LxW)  
**Material** Stainless Steel 304 & Polypropylene  
**Applicable Sink Model** UBG

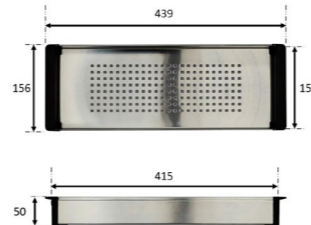

**Model**  
 230-106  
**Suggested Retail Price**  
**\$480**



**Overall Size** 405 x 157 x 55mm (LxWxH)  
**Bowl Outer Size** 372 x 132mm (LxW)  
**Material** Stainless Steel  
**Applicable Sink Model**  
 MRG, BLG 611-97

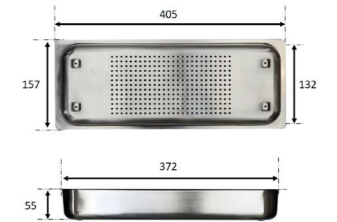

**Model**  
 230-115  
**Suggested Retail Price**  
**\$250**



**Overall Size** 428 x 157 x 50mm (LxWxH)  
**Bowl Outer Size** 404 x 153mm (LxW)  
**Material** Stainless Steel 304 & Polypropylene  
**Applicable Sink Model** KNG, BXX

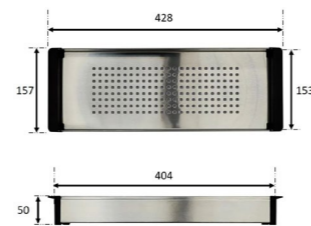

**Model**  
 230-093  
**Suggested Retail Price**  
**\$430**



**Overall Size** 434 x 190 x 80mm (LxWxH)  
**Bowl Outer Size** 398 x 155mm (LxW)  
**Material** Polypropylene  
**Applicable Sink Model** BCX 110-42,  
 BCX 611-86, BCX 621, BCX 620-38-32,  
 BCX 620-42-35



**Model**  
 230-104  
**Suggested Retail Price**  
**\$50**





## ROLLER MAT



**Overall Size** 468 x 440mm (LxW)  
**Material** Stainless Steel  
**Applicable for all sink model**

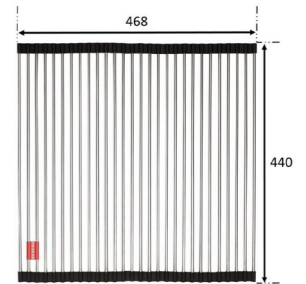

**Model**  
 210-414  
**Suggested Retail Price**  
**\$420**



**Overall Size** 298 x 410mm (LxW)  
**Material** Stainless Steel  
**Applicable Sink Model** KNG, FEX, BCX 610-51,  
 BCX 621, BCX 120-35-35, BCX 620-38-32

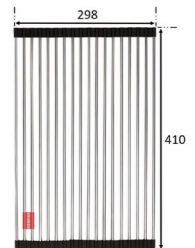

**Model**  
 210-427  
**Suggested Retail Price**  
**\$270**



## CHOPPING BOARD



**Overall Size** 442 x 230 x 20mm (LxWxH)

**Inner Size** 421 x 188mm (LxW)

**Material** Wooden

**Applicable Sink Model** KNG, UBG

**Model**  
200-302  
**Suggested Retail Price**  
**\$300**



**Overall Size** 532 x 280 (LxW)

**Inner Size** 503 x 22mm (LxH)

**Material** Bamboo

**Applicable for all sink models**

**Model**  
200-310  
**Suggested Retail Price**  
**\$240**



**Overall Size** 430 x 225 x 18mm (LxWxH)

**Inner Size** 408 x 172 (LxW)

**Material** Bamboo

**Applicable Sink Model** BXX, BCX 620-42-35

**Model**  
200-292  
**Suggested Retail Price**  
**\$160**





## SINK WASTES - GRANITE SINK



**Type** Waste Kit Set in ONYX [NEW] (Sanitized)  
**Model** 112.0658.444  
**Price** \$680



**Type** Waste Kit Set in Onyx (Sanitized)  
**Model** 112.0658.484  
**Price** \$980



**Type** Deeper Waste without Overflow (Sanitized)  
**Model** 440-180  
**Price** \$260



**Type** Waste Set without Overflow  
**Model** 440-153/440-190/440-198  
**Price** \$210



**Type** Deeper Waste with Overflow Set  
**Model** 440-179 + 460-179  
**Price** \$360



**Type** Low Profile Waste without Overflow  
**Model** 440-177  
**Price** \$160



**Type** Low Profile Waste with Overflow Set  
**Model** 440-194 + 460-116  
**Price** \$240



**Type** POP-UP Waste with Overflow Set  
**Model** 440-185 + 460-184 + 460-116  
**Price** \$1,200

MRG 610									
MRG 660/ 620									
KNG 110-37/ 110-52									
KNG 120									
UBG 610-56/ 610-78									
UBG 620-86									
BLG 611-97									

\*Price = Suggested Retail Price



## SINK WASTES - STAINLESS STEEL SINK

 SWITZERLAND



**Type** Waste Set with Overflow Set  
**Model** 112.0049.409 + 133.0036.506  
**Price** \$260  
 MRX Exclusive



**Type** Waste Set without Overflow  
**Model** 440-195  
**Price** \$110



**Type** Waste Set without Overflow  
**Model** 440-153/440-190/440-198  
**Price** \$210



**Type** Deeper Waste without Overflow (Sanitized)  
**Model** 440-180  
**Price** \$260



**Type** Deeper Waste with Overflow Set  
**Model** 440-179 + 460-179  
**Price** \$360



**Type** Low Profile Waste without Overflow  
**Model** 440-177  
**Price** \$160



**Type** Low Profile Waste Kit with Overflow Set  
**Model** 440-194 + 460-108  
**Price** \$240



**Type** POP-UP Waste with Overflow Set  
**Model** 440-184 + 460-184 + 460-116  
**Price** \$1,200

MRX



BXX



FEX



BCX 110/ 610/ 611



BCX 621/ 120-35-35/ 620



\*Price = Suggested Retail Price





# Tap

## Overview

### Taps Worth Talking About

The perfect kitchen tap combines form and function, making your life easier and your kitchen renowned for design, quality components, and rigorous manufacturing processes. With the acquisition of Switzerland, Franke has gained a strong partner and increased expertise in high-end tap manufacturing and design.



# Highlights

Kitchen taps designed to the finest standards



Explore endless shape, line and contour possibilities to make an ordinary kitchen something special. The Franke tap range provides your kitchen with a focal point – and in some cases, a talking point. Featuring cutting edge design and a whole host of innovative features to enhance your lifestyle – from filtered cold water, to instant boiling water - the range spans the entire spectrum of form and function.



## Design

Franke's line of kitchen taps perfectly captures all the elements of today's design choices – traditional, transitional, and contemporary. With everything from top flight European models with a sleek minimalist line, to classic models that are the centerpiece to any kitchen, the addition of a Franke tap can reinvigorate an existing kitchen or make a statement all its own in a fresh design.

## Manufacturing

Outstanding design and quality components come together beautifully in our manufacturing process. Strict adherence to Franke manufacturing standards in forming, finishing and final assembly achieve the exceptional quality and durability that makes a Franke tap one of the most desired additions to a kitchen.



## Hygiene

Superior materials with corrosion resistant and easy-cleaning features guarantee that no harmful materials enter the taps' flow of water.



## Durability

Scratch and acid resistant features of high quality SUS304 stainless steel ensures our tap have a much longer lifecycle.



## Functionality

Ceramic cartridges provide uniform temperature and water flow transmissions, as well as superior water-saving capabilities.



## Design Award

Thanks to its outstanding quality and cutting-edge design, the Franke Pescara range of taps has received the 2017 iF Gold Award and the Red Dot design award.





# Brass Tap

Brass is one of the most common materials in tap making, found all around the world. Its material characteristics make it possible to create a wide range of tap shapes and styles, and chrome finishing provides a shiny look perfect for contemporary kitchen styles.

## BRASS TAP

MARIS

**Model**  
Active L pull out spray  
**Model No.**  
115.0653.384  
**Suggested Retail Price**  
**\$3,080**



**Material** Brass  
**Finish** Onyx  
**Pull Out** Yes  
**Nozzle / Spray** Spray  
**Hose Diameter** 3/8"

ITALY  
Onyx

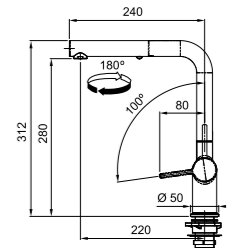

MARIS

**Model**  
Active L pull out spray  
**Model No.**  
115.0653.385  
**Suggested Retail Price**  
**\$3,080**



**Material** Brass  
**Finish** Stone Grey  
**Pull Out** Yes  
**Nozzle / Spray** Spray  
**Hose Diameter** 3/8"

ITALY  
Stone Grey

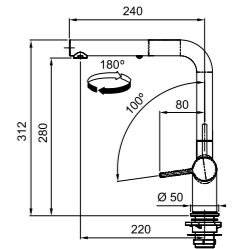

MARIS

**Model**  
Active L pull out spray  
**Model No.**  
115.0653.379  
**Suggested Retail Price**  
**\$2,580**



**Material** Brass  
**Finish** Chrome  
**Pull Out** Yes  
**Nozzle / Spray** Spray  
**Hose Diameter** 3/8"

ITALY  
Chrome

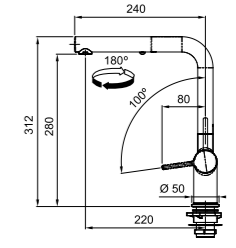

MYTHOS

**Model**  
Icon Swivel  
**Model No.**  
PT 905G  
**Suggested Retail Price**  
**\$4,580**



**Material** Brass  
**Finish** Matt Black  
**Pull Out** No  
**Nozzle / Spray** Nozzle  
**Hose Diameter** 3/8"

red dot design award winner 2021

ITALY  
Matt Black

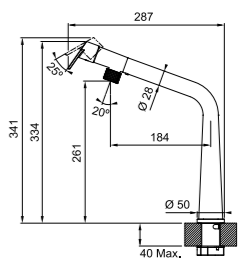



BRASS TAP

MARIS



**Material** Brass  
**Finish** Onyx  
**Pull Out** No  
**Nozzle / Spray** Nozzle  
**Hose Diameter** 3/8"

**Model**  
 Active L swivel  
**Model No.**  
 115.0653.373  
**Suggested Retail Price**  
**\$1,880**

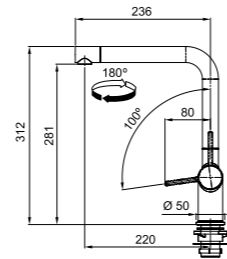
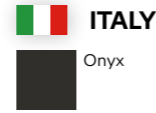

MARIS



**Material** Brass  
**Finish** Stone Grey  
**Pull Out** No  
**Nozzle / Spray** Nozzle  
**Hose Diameter** 3/8"

**Model**  
 Active L swivel  
**Model No.**  
 115.0653.374  
**Suggested Retail Price**  
**\$1,880**

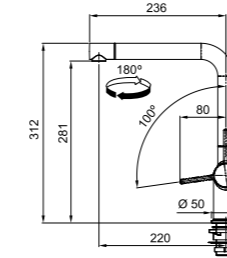
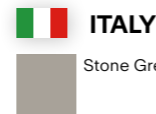

MARIS



**Material** Brass  
**Finish** Chrome  
**Pull Out** No  
**Nozzle / Spray** Nozzle  
**Hose Diameter** 3/8"

**Model**  
 Active L swivel  
**Model No.**  
 115.0653.298  
**Suggested Retail Price**  
**\$1,680**

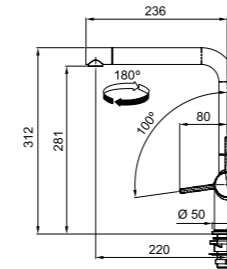

BRASS TAP

SMART



**Material** Brass  
**Finish** Onyx  
**Pull Out** Yes  
**Nozzle / Spray** Nozzle  
**Hose Diameter** 1/2"

**Model**  
 Lina  
**Model No.**  
 CT 933G  
**Suggested Retail Price**  
**\$1,880**

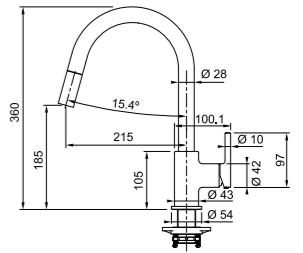

SMART



**Material** Brass  
**Finish** Chrome  
**Pull Out** Yes  
**Nozzle / Spray** Nozzle  
**Hose Diameter** 1/2"

**Model**  
 Lina  
**Model No.**  
 CT 933C  
**Suggested Retail Price**  
**\$1,880**

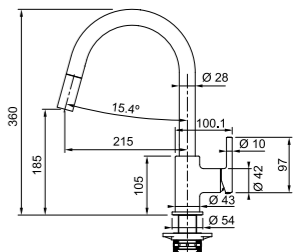

SMART



**Material** Brass  
**Finish** Onyx  
**Pull Out** No  
**Nozzle / Spray** Nozzle  
**Hose Diameter** 1/2"

**Model**  
 Lina  
**Model No.**  
 CT 9020G  
**Suggested Retail Price**  
**\$1,580**

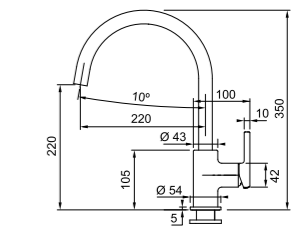

SMART



**Material** Brass  
**Finish** Chrome  
**Pull Out** No  
**Nozzle / Spray** Nozzle  
**Hose Diameter** 1/2"

**Model**  
 Lina  
**Model No.**  
 CT 9020C  
**Suggested Retail Price**  
**\$1,580**

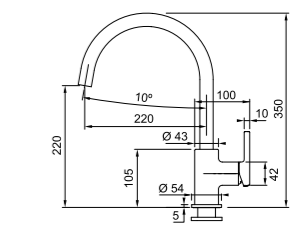



# Stainless Steel Tap

Durable and easy to maintain, stainless steel is also lead-free, making it completely safe for your family. A brushed stain finishing is also an elegant complement to stainless steel sinks and appliances.



MARIS



**Model No.**  
Atlas Neo CT 1310S  
**Suggested Retail Price**  
**\$2,380**

**Material** Stainless Steel  
**Finish** Satin  
**Pull Out** Yes  
**Nozzle / Spray** Nozzle  
**Hose Diameter** 3/8"

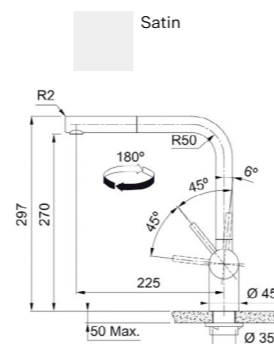

## Clean & Care Overview

General maintenance is wonderfully simple. Increase the lifespan of your Franke products and prevent the buildup of dirt and limescale by simply wiping down your sink and all stainless steel surfaces with a damp cloth and soapy water. This simple tip will keep your products looking great. Discover more top cleaning tips below.



ITALY

**Model 112.0530.239**  
Tap Cleaner ( 250ml)

Suitable for daily maintenance

**Suggested Retail Price**  
**\$230**

When looking at a shiny tap, one tends to forget all the technology and mechanics tucked inside. There are valves, cartridges, seals, and filters that might get harmed if you use an aggressive cleaner. The Franke Kitchen Care Tap Cleaner removes all lime scale and dirt gently but thoroughly, thus preserving the beauty and performance of your tap for years.



ITALY

**Model 112.0530.324**  
Microfiber Care Cloth

**Suggested Retail Price**  
**\$180**

When combined with the Franke Kitchen Care Microfiber Care Cloth, each of cleaning detergents is more effective and more protective than with any other cloth or sponge. Thanks to its unique structure, the fiber absorbs even the smallest dirt particles while smoothly polishing the surface. Washable at up to 60°C and suitable for tumble drying, the cloth can be used over and over again to keep your kitchen clean and shiny.





# Food Waste Disposer

## Overview

### More Choice, More Space

A food waste disposer unit can be a wonderful, long-lasting addition to any kitchen if proper care is taken.

Food waste disposer units are designed to deal with small amounts of organic waste: fruit and vegetable peels, small bones from fish and chicken, coffee grounds, pips and seeds, nutshells, eggshells, rice and leftover meat. To prevent any problems, avoid putting teabags, seafood shells, corn cobs, banana skins, pineapple leaves or metal, glass, plastic and paper down the unit. Plus, to keep things smelling clean and fresh, don't use drain cleaner – instead, squirt a few drops of lemon juice.



- Torque Talk**
- Permanent magnet motor
  - Torque master grinding system

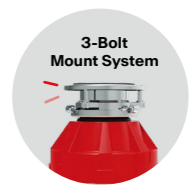

- Magnetic Magic**
- Energy saving
  - Less is more



- Here to stay**
- 3-bolt mount system
  - Corrosion resistance



- Clean Slate**
- Bio Shield
  - Removeable splashguards



# Highlights

A greener, simpler and quieter choice



## Less is More

Quickly shred and pulp food waste material into small pieces that are then flushed down the drain at a 2700RPM motor speed. This process releases water trapped inside the food material (which can form up to 85% of its bulk), thereby helping to reduce the volume of food waste released from your home.

## Health and Hygiene

Food waste in the kitchen is not only messy and inconvenient, but can also lead to hygiene problems. Fish, meat and dairy products can spoil quickly, resulting in a plethora of germs and insects – particularly in a warm environment. A Turbo Elite series food waste disposer is the simple, convenient and hygienic answer.

## Safety Comes First

Equipped with complete features and systems for safe use, our Turbo Elite series food waste disposer ensures full functionality for a less wasteful home without any worry over safety or accidents.



## FOOD WASTE DISPOSER



FWDA03B-01  
Retail Selling Price \$40

**Model**  
Turbo Elite  
**Model No.**  
TE-125  
**Suggested Retail Price**  
**\$5,280**

**Type** Continuous Feed  
**Dimension** ø200 x 406mm  
**Grind Chamber Capacity** 1,400ml  
**Motor Horsepower** 1.25HP  
**Motor Speed RPM** 2,800RPM  
**Motor Type** High Torque Dual Magnetic  
**Air Switch** Integral  
**Mounting System** Professional 3-bolt  
**Warranty** 2 Years

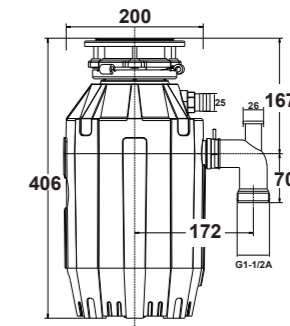

FWDA03B-01  
Retail Selling Price \$40

**Model**  
Turbo Elite Slimline  
**Model No.**  
TE-75S  
**Suggested Retail Price**  
**\$2,880**

**Type** Continuous Feed  
**Dimension** ø158 x 386mm  
**Grind Chamber Capacity** 1,400ml  
**Motor Horsepower** 0.75HP  
**Motor Speed** 2,700RPM  
**Motor Type** High Torque Dual Magnetic  
**Air Switch** Integral  
**Mounting System** Professional 3-bolt  
**Warranty** 2 Years

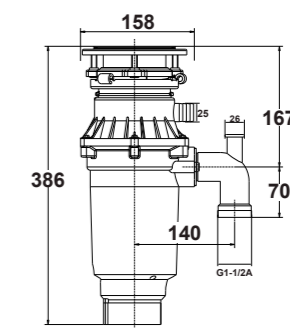

\* The food waste disposer is recommended to use in private household only



## PROJECT REFERENCE

(BY ASCENDING ORDER)

### HONG KONG

PROJECT	DEVELOPER
Billionaire Avant 御門·前	Chinachem 華懋
Cathay Pacific Cargo Terminal HK 國泰航空貨運站	Cathay Pacific Airlines Ltd. 國泰航空
Centre Point 尚賢居	Henderson Land 恒基
Cityplaza Phase 3 太古城中心3期	Swire Properties 太古
Dragons Range 玫瑰山	Kerry 嘉里
Eden Gate 雲門	Chinachem 華懋
Eltanin Square Mile 利奧坊·曉岸	Henderson Land 恒基
Emerald Bay 碧瓏灣	Evergrande 中國恒大集團
Facebook Hong Kong	Facebook Hong Kong
Grand Hyatt HK Renovation 香港君悅酒店	Grand Hyatt 君悅酒店
Harmony Place 樂融軒	Housing Society 香港房屋協會
HKUST Campus 香港科技大學	HKUST 香港科技大學
Horizon Suite Hotel 海澄軒	Cheung Kong Holdings 長江
Island Garden 香島	Nan Fung 南豐
JW Marriot HK 萬豪酒店	Marriott International Group 萬豪
K.K. Leung Building, HKU 香港大學梁銶琚樓	HKU 香港大學
Lepont 上源	Vanke 萬科
MacPherson Place 麥花臣匯	Kowloon Development 九龍建業
Mantin Heights 皓畝	Kerry 嘉里
Maya 曦臺	Wang On 宏安
Mount Nicholson 聶高信山	Wheelock 會德豐
132 Nga Tsin Wai Road 衙前圍道132號	TK Tsui
1 Oxford Road 牛津道一號	China Overseas 中國海外
77 Peak Road 山頂道77號	Wheelock 會德豐
11 Plantation Road 種植道11號	Wheelock 會德豐
Providence Bay Clubhouse 天賦海灣	Nan Fung 南豐
Rosewood Hotel 瑰麗酒店	New World Development 新世界

### HONG KONG

PROJECT	DEVELOPER
Sheung Heung Road Project 上鄉道發展項目	New World Development 新世界
St. Martin 雲滙	Sun Hung Kai Properties 新鴻基
St. Paul's Hospital 聖保祿醫院	St. Paul's Hospital 聖保祿醫院
The Beaumont 峻滢	Cheung Kong Holdings 長江
The Bloomsway 滿名山	Kerry 嘉里
The Entrance 峻源	Citic 中信集團
The Hong Kong Polytechnic University 香港理工大學	The Hong Kong Polytechnic University 香港理工大學
The Met. Acappella 薈薈	Wang On 宏安地產
The Signature 春暉8號	New World Development 新世界
The Visionary 昇薈	Nan Fung 南豐
Towngas Cooking Center Causeway Bay 銅鑼灣煤氣烹飪中心	Towngas 中華煤氣
Vibe Centro 龍譽	Poly Property 保利置業
Winfield 雲暉大廈	Nan Fung 南豐

### MACAU

PROJECT	DEVELOPER
JW Marriot, Galaxy Resort, Macau 萬豪酒店	Galaxy Entertainment Group 銀河娛樂
La Marina 海上居	Polytec Asset Group 保利達
Lotes T+T1, The Orient Pearl District, Novos Aterros da Perta, Macau	Polytec Asset Group 保利達
MGM Cotai Macau 美獅美高梅酒店	MGM China Holdings 美高梅中國控股
Nova City Phase 5 濠庭都會 - 濠尚	Shun Tak 信德
Rua da Ribeira do Patane, Macau 鏡湖醫院	鏡湖醫院基金會
The Venetian Hotel Resort, Macau 澳門威尼斯人	The Venetian Macau Limited 澳門威尼斯人



## WARRANTY TERMS

The warranty for manufacturing defects on this FRANKE device is 3 years from the date of purchase (Faucet cartridge is 5 years from the date of purchase). The customer must inform FRANKE about all faults within 2 months of determination. FRANKE must always be provided with the proof of purchase stating the vendor/retailer, purchase date and product identification number.

The manufacturer's warranty is only granted under the following conditions:

- The device is only used in a private household.
- The device was connected as per the manufacturer's instructions and all essential energy regulations were complied with when connecting as per the supplied operating instructions.
- The device is only used in line with the instructions in the operating instructions.
- All repairs are implemented by an authorised FRANKE customer service centre and FRANKE spare parts were used.
- The model or serial number on the product was not changed, deleted, removed or otherwise made illegible.

During the warranty period FRANKE will either repair or replace defective parts for the customer free of charge.

FRANKE has the right to replace the defective device with one of the same value if defects occur repeatedly or if the repair costs bear no relationship to the value of the goods.

There is no right to repairing or replacing the device beyond the warranty period of 1 year.

## EXCLUSION CLAUSES

This FRANKE warranty does not cover repair or spare part costs arising for the following reasons:

- The operating or maintenance instructions from the manual provided were not met.
- The device was operated in a negligent or grossly negligent manner.
- The maintenance or repair was undertaken by an unauthorised person or the customer and/or no original spare parts were used.
- Due to transport damage or damage arising from force majeure and/

or events that cannot be specified as manufacturing defects on the device.

- Parts that can be removed, handles, light bulbs, enamel or glass parts, external tubes and all components and wear parts are not covered by this warranty unless it can be proven that they have manufacturing defects.
  - Damage to the product caused by the installer and operating faults caused by incorrect installation.
  - Defects on the systems and fittings with which the device was linked.
- This is why the customer has to provide full payment for any service call and spare parts if requesting an authorised employee from the customer service centre in these cases.

## EXTENT OF AREA

This warranty is guaranteed by FRANKE in the area of the stated country by the customer service network.

Devices sold or used in other countries are covered by the warranty of the FRANKE Group company in the respective country.

## MANUFACTURER'S LIABILITY RESTRICTIONS

FRANKE does not accept any liability whatsoever for damage to people, property or animals created directly or indirectly as a result of not complying with the instructions in the operating manual, in particular with regard to the installation, operation and maintenance of the device.

## EXPIRY OF THE WARRANTY

After the end of the 3 years warranty period, all service calls to customer services for a repair or replacement of components must be paid for in full by the customer, as per the price lists of the authorised FRANKE customer service. In the event that a defective product is repaired or replaced, the warranty applies to the repaired or new product only for the same time as the original warranty on the product.

If you want to contact FRANKE for a service call, please provide the purchase receipt and the following information:

- Model / serial / product no.

You will find this information on the device's nameplate.

- Date of purchase

### WARRANTY PERIOD

### PRODUCTS COVERED

#### 3 YEARS

Granite sink, Stainless Steel sink, Brass tap, Stainless Steel tap

#### 2 YEARS

Food waste disposer

#### 1 YEAR

Strainer Bowl, Roller Mat, Soap Dispenser, Chopping Board

### PRODUCTS NOT COVERED UNDER WARRANTY PERIOD

Cleaning accessories, spare parts

\* The above warranty terms only apply to Hong Kong

\* For detailed warranty terms and conditions, please visit [www.bkee.com/bkee\\_warranty](http://www.bkee.com/bkee_warranty)

